

Model DEB LED Lamp
Recommended Product
For more details on Model DEB
Refer to the "Replacement Bulb"
Section at the end of this Catalog



SKH-EA

Revolving Warning Light



Bulb

IP23

Ø100

Best-selling Revolving Warning Light for wide range of applications.

FEATURES

- Indoors allows upright, inverted, and sideways installation; outdoors allows upright installation only.
- Has the CE mark and conforms to the requirements (for 12V, 24V type only) for the EC directive.
- Dome is made from superior weather-resistant and light-translucent acrylic resin.
- Rotating parabolic reflector to enhance visibility from a distance.
- Vibration-resistant automobile bulb for extended bulb life.
- Available Colors are Red, Amber, Green, and Blue.

Specifications

| Series | Model | Rated Voltage | Current Consumption | Flash Rate (fpm) | Bulb | | Mass |
|------------------|-----------|---------------|---------------------|------------------|---------|-----------|------|
| | | | | | Ratings | Repl. No. | |
| USA Version | SKH-12EA | DC 12V | 0.8A | 170 | 12V 10W | 9 | 400g |
| | SKH-24EA | DC 24V | 0.5A | | 24V 10W | 10 | |
| | SKH-120EA | AC 120V | 0.07A | | 12V 5W | 12 | 600g |
| Standard Version | SKH-12EA | DC 12V | 0.8A | | 12V 10W | 9 | 400g |
| | SKH-24EA | DC 24V | 0.5A | | 24V 10W | 10 | |
| | SKH-100EA | AC 120V | 0.065A | | 12V 5W | 12 | 600g |
| | SKH-200EA | AC 200V | 0.03A | | | | |

How to Order

| | | |
|---|------------|-------|
| SKH- | EA- | |
| Model | | Color |
| Rated Voltage | | |
| 12 : DC 12V | | |
| 24 : DC 24V | | |
| 100: AC 100V | | |
| 120: AC 120V | | |
| 200: AC 200V | | |
| R: Red Y: Amber G: Green B: Blue | | |

Dimensions

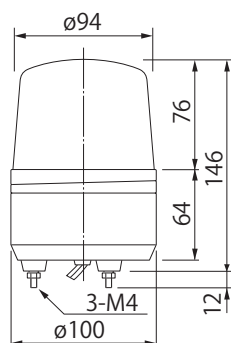

Mounting Dimensions

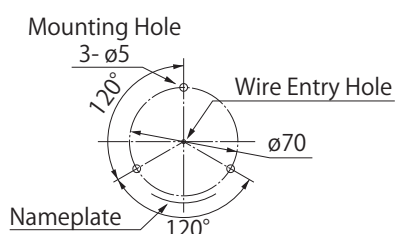

(Unit: mm)